

In General

Please inspect your product carefully. If any of the product appears damaged when you open the box do not attempt to install it. **IF YOU ENCOUNTER ANY CONDITION OR DEFECTS DURING INSTALLATION WHICH COULD JEOPARDIZE THE INSTALLATION OR AFFECT THE INSTALLATION PROCEDURE YOU SHOULD STOP THE INSTALLATION IMMEDIATELY AND CONTACT SELECTECH'S CUSTOMER SERVICE DESK. 508.583.3200**

Place N' Go Basics

Place N' Go is an 18.5" x 18.5" interlocking floor tile. It is a free-lay tile system and does not require use of adhesives. Place N' Go's "built-in" subfloor permits installation over uneven surfaces with minimal preparation of the floor.

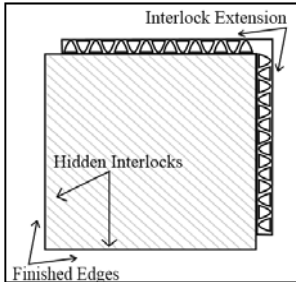

The interlock system uses two Interlock Extensions that are visible from the top of the tile, and two (2) interlocks under the Finished Edges that are visible from the bottom of the tile. To install, you will mate the interlocks under the Finished Edges on one tile with the Interlock Extensions on adjacent tiles.

Tile Flatness

Place N' Go utilizes a patented "zipper" interlock system, designed for adhesive free installation and providing tight seams, with a flexible, moisture proof base manufactured with high recycled content. This design results in a slight dipping at the edges of the tile which is normal. Some amount of "cupping" may also be present on initial installation. This will diminish over time as the floor "settles in" following installation.

How Much do I Need?

Measure the length and width of your room. If there are alcoves or jogs in the room measure them separately. Add these together to get your square footage. Most installations require 5% to 10% extra to cover trimming. Actual waste factors will vary based on job size, layout, installation experience and other factors. Place N' Go tiles are sold in boxes of 8 tiles each. Round up to nearest full box size.

Tile Size: 18.5" x 18.5" = 2.38 sq. ft./tile

Box Size: 8 tiles/box = 19.04 sq. ft./box

Receiving and Storing Place N' Go

Place N' Go must be stored flat and at room temperature prior to installation. Never store the tiles upright. Stack the boxes of tiles (or loose tiles) on a flat surface with the edges of the boxes flush to one another. Improper storage or overhanging edges will distort the shape of the tiles and cause difficulty when installing.

Tools

- Dead-blow hammer (21 to 42 oz) (Required) available at hardware stores **NOTE: Rubber mallets do not work**
- Utility knife in conjunction with a straight edge. (Required)
- Carpenter's square. (Required)
- Chalk line (Required)
- Table saw or circular saw (for making multiple straight cuts). (Required)
- Jig saw, orbital or similar cutting tool for irregular cuts. Use a fine tooth finishing blade (Recommended)

Preparation

KEEP TEMPERATURE OF THE ROOM, SUBFLOOR, AND TILE AT A MINIMUM OF 65 °F (18°C) TO A MAXIMUM OF 85°F (29°C) FOR AT LEAST 48 HOURS PRIOR TO INSTALLATION IF THE TILES HAVE BEEN SHIPPED IN EXTREME WEATHER CONDITIONS, UNDER 40°F (4°C) OR OVER 95°F THE CONDITIONING TIME SHOULD BE A MINIMUM OF 72 HOURS.

- Remove all debris. Sweep and vacuum as necessary.
- Scrape off old adhesive. The surface does not have to be perfect but do remove large clumps of adhesive (> 1/16" high)
- Remove moldings or cove base. You will reinstall old moldings/cove base or new ones over the floor after completion.
- Repair any major surface imperfections (cracks over 3/8") sharp height transitions or voids in the subfloor.
- 1/4" spacers (alternatively, use cut pieces from tiles as spacers)
- If necessary undercut door frames to allow tiles to fit underneath. (Instructions below)

WARNING: Appropriate caution and procedures must be used if removing a pre-existing resilient floor covering. Many older vinyl sheets, floor tile or asphaltic floor coverings contain asbestos that is not readily identifiable. Removal of these materials must comply with various federal, state and local regulations pertaining to the removal of in-place asbestos. Do not sand, dry sweep, dry scrape, drill, saw bead blast or pulverize any such existing product(s) unless you are certain they do not contain asbestos.

Establishing a Starting Point

Like all tile products, layout planning begins by finding the center of the room or area to be covered and establishing perpendicular lines to guide your layout. Unlike ceramic or vinyl tile products, Place N' Go installations should start in the corner of the room with the finished edges facing the wall.

Use the method outlined below to create Control Lines along the two walls that meet at the starting corner. Using these methods will provide a square installation with balanced cut rows along each wall. For simpler installation with fewer cuts see Step 7.

1. Determine which corner will be your starting point. Do not start in a corner with a doorway.
2. Measure and mark the center of each of the four walls and mark them with chalk. Use a chalk line to draw a straight line between center spots on the opposing walls. These lines divide the area into four equal quadrants. The intersection of these lines is the center point of the room. Check where the lines cross with a carpenter square to make absolutely sure the center point is square.

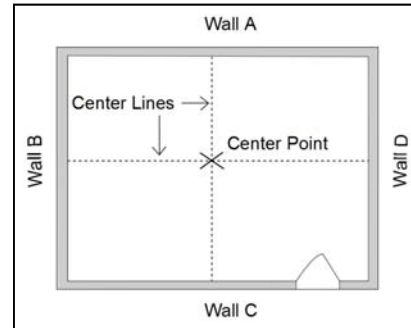

3. Starting from the intersection of the Center Lines determine how many full rows of tiles are required in each direction. You may determine this either by calculation (using multiples of 18 1/2") or by laying tiles along the lines to the walls. **NOTE:** The hidden Interlock Extension which extends beyond the top, finished surface, is not to be included in these measurements.
4. The Finished Edge of the last full tile will establish your Control line. Place the carpenter's square along the Centerline at that point and draw a perpendicular line along Wall A (line BD).
5. Repeat the process along Wall B (line AC).

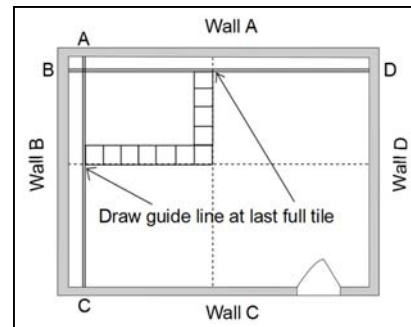

6. The intersection of lines AC and BD is your starting point.

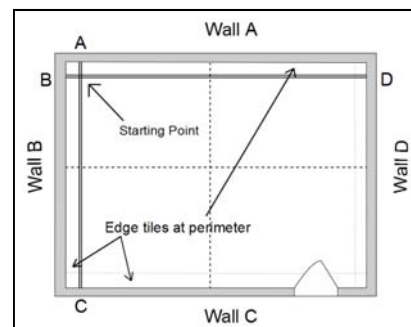

- Following Step 5, if you find that the tile required to fill the final cut row along the wall is less than 1/3 of a tile you may want to begin with a full tile closest to the wall. In this case, or if you simply prefer the simpler installation with less cutting, follow all of the steps above. You will still draw two Control Lines but they will be close to the two starting walls, leaving the required 1/4" gap for expansion. Measure from the center line to a point 3/8" from the wall. Use the carpenter's square to establish a perpendicular line. Snap a chalk line along the wall. This is your starting line.

Installing "Field" Tiles

The design of Place N' Go requires that the tiles must always be installed in the same rotational direction and with edges and corners in line with each other. Trying to install otherwise can damage the tiles. Position the first tile in the selected starting corner. Make sure it is aligned with and flush with both lines. Orient the tiles as shown below:

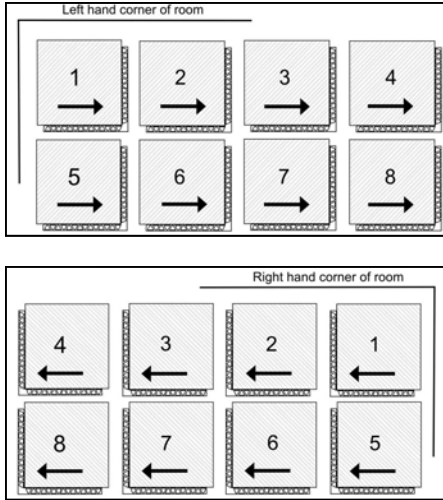

Install the first row. Keep the first row flush to Control Lines at all times. When the first row is complete, return to the starting corner and begin another row. Continue until the Field are installed.

- To install each tile make sure it is properly aligned with the adjoining tile(s) and that the interlocks and the floor are free of debris. Align the corners and interlocks of each tile, placing a "Finished Edge" over the Interlock Extension. Push down on the tile with the heel of your hand until you feel and see the tile has seated on the adjacent tile at the corner.



- Gradually work along the edge of the interlock tapping firmly with the dead-blow hammer until the edge is fully interlocked and seated.



IF TILES ARE NOT INTERLOCKING WITH RELATIVE EASE RECHECK FOR PROPER ROTATION AND ALIGNMENT BY REMOVING THE TILE AND STARTING THE INTERLOCK ENGAGEMENT WITH THE HEEL OF YOUR HAND AGAIN BEFORE TAPPING JOINT TOGETHER. CONTINUING TO HIT IMPROPERLY ALIGNED TILES WILL DAMAGE THE INTERLOCKS.

Due to the flexibility of the material and the tight seam design, some edges may pop up during installation. THIS IS NORMAL. Tiles may be resealed with the hammer or with a roller when installation is complete. Seams will settle as the floor settles.

Measuring and Laying Cut Edge Tiles

- Create an end cut template by cleanly removing the interlock extensions from one tile.
- Beginning in a corner, place a loose tile over the installed corner tile. Line up the edges precisely. BE SURE THE INTERLOCKS ARE ORIENTED THE SAME WAY AS THE INSTALLED TILE.
- Lay the End Cut Template over the loose tile to be cut. Butt the template against the wall, placing 1/4" expansion spacers near the corners (you may use a "slice" of a tile to achieve a 5/16" space). Line up the other edges and mark a line where the template meets the loose tile.



Remove the marked tile and cut along the drawn line.

- If required, gently lift the edge of the "field tile" and slide the cut tile Interlock Extension under the "field tile". Butt tiles together and align corners. Seat the tile corner with the heel of your hand. Use a dead blow hammer to finish seating the edges. Check to ensure minimum expansion space.
- Continue using this method around the perimeter of the room until all tiles are installed.
- For the best finish you will need to cut the door jamb moldings so the tiles fit freely under them. This is easily done with a "door jamb" or "undercut" saw available at most hardware stores. Cut the jamb using a tile to establish the proper cutting height.



Note: In some cases you will also have to cut the door bottom due to inadequate clearance. Your door should not rub anywhere on the tile when it is open and shut.

- For best interlock joint seating, roll over all joints with a laminate j-roller, or equivalent, applying pressure to the joints as you roll across them. You may want to repeat this process after the floor has had a chance to "settle in" for a few days. You may also go back over the floor re-tapping any high points with the dead-blow hammer.

Finishing Edges & Transitions

Quarter round or other trim moldings may be used to cover expansion edges around the perimeter of your room. You may fill gaps around other room obstructions with colored caulking. To transition to adjacent flooring install a transition molding. An aluminum reducer for 5/16" flooring can be purchased from SelecTech. Other transitions are available through flooring retailers and distributors.

For unusual conditions or extraordinary installations, contact SelecTech for guidance (877-738-4537)

For additional Product Information and to ensure that you have the most recent instructions visit Placengo.com